Deciding What Plants to Bring with You to Oregon

A checklist to protect the health and safety of Oregon's natural and economic resources

For each plant, go through the following checklist.

A plant must check all the boxes to be able to move with you to Oregon.

For more details about regulations, visit Oregon Department of Agriculture's webpage on Moving Plants at:

<https://www.oregon.gov/oda/programs/NurseryChristmasTree/ShippingPlantMaterial/Pages/MovingHouseplants.aspx>

For more information on the problem pests you are helping to prevent and how these pests can harm Oregon's environment and economy, visit:

<https://www.oregoninvasivespeciescouncil.org/>.

- Is the plant allowed?

- **Some plants are prohibited** from entering the state of Oregon due to concerns about the introduction of invasive or unwanted species, which cause millions of dollars in damages every year.
 - To find out if your plant is a prohibited Noxious Weed, visit the Oregon Department of Agriculture Noxious Weeds search tool to search for your plants in the lists of Noxious Weeds at: <https://www.oregon.gov/oda/programs/weeds/oregonnoxiousweeds/pages/aboutoregonweeds.aspx>
 - You can find a list of restricted plant species on the National Plant Board Noxious Weeds and restricted plants pdf at <https://nationalplantboard.org/wp-content/uploads/docs/summaries/oregon.pdf>
 - Unsure about the status of any of your plants? Contact the ODA Plant Program at 503-986-4636 to check
 - For more information about Noxious Weeds and their regulation, visit Oregon Department of Agriculture's page on Noxious Weeds at www.oregon.gov/oda/programs/Weeds/OregonNoxiousWeeds/Pages/Law.aspx
-

- Is the plant healthy?

- Only bring healthy plants free of pests and pathogens
 - Concerning symptoms include: unusual or unseasonable foliage loss, wilting, discoloration, spotting, streaking, bite marks, and chew or bore holes
 - Unsure about the health of any of your plants?
Contact your local university extension office or department of agriculture.
-

- For outdoor plants, can it become an indoor potted plant?

- Oregon requires that any plants that were outdoors must be turned into indoor potted plants and remain indoors indefinitely

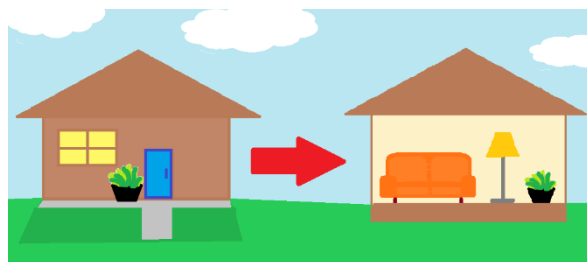

Deciding What Plants to Bring with You to Oregon

A checklist to protect the health and safety of Oregon's natural and economic resources

- **Is it a priority?**

- Oregon Department of Agriculture allows up to 5 plants to be brought into Oregon for non-commercial purposes

**Thank you for doing your part to help protect your new home state!
Your plants and Oregon's environment and economy thank you!**